

WALLYPOWER 58X - WALLY

Hull number: 02 - year of built: 2023



MAIN FEATURES

BUILDER	WALLY	MODEL	WALLYPOWER 58X
HULL NUMBER	02	TYPE	Motor Yachts
HULL TYPE	Planing	BOAT NAME	WALLEYE
YEAR	2023	ARCHITECT	Luca Bassani
HULL COLOUR	Metallic Silver with matching engine covers	INTERNA WOODS	Teak Alpi
CONSTRUCTION MATERIAL	Fiberglass - VTR	LOA	17.50 [m] - 57.41 [ft]
BEAM	5.00 [m] - 16.40 [ft]	DRAFT	1.30 [m] - 4.27 [ft]
ENGINES	4 x Mercury Verado V12	CRUISING SPEED	38 [kn]
MAX SPEED	50 [kn]	N° GUEST CABIN	1
N° CREW CABIN	0	N. TOILETS	2
DISPLACEMENT	27,500 [kg]	ON DISPLAY AT/IN	Golfe Juan
COUNTRY	France	FLAG	Cayman Islands
ASKING PRICE	2,500,000.00 [euro]	VAT STATUS	Not paid



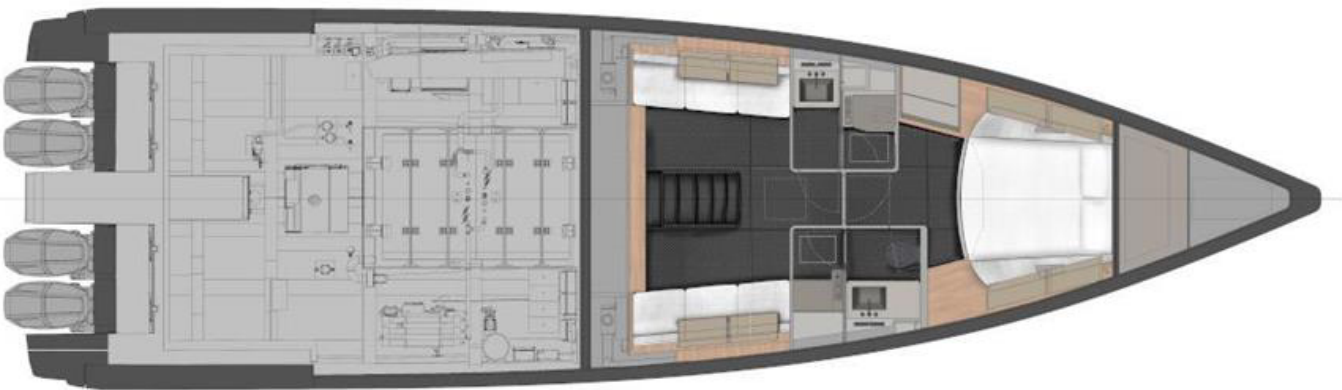

Technical information

Engines hours	111
Trasmissions	Outboard
Propellers	DuoProp
Main generator	15kw Mase
Main generator hours	166

Fuel tank	4200 litres
Water tank	450 litres
Charge batteries	Yes
Inverter	Yes

Description per area

General description

The remarkable new Wallypower 58X embraces the familiar walkaround design found in the existing Wallypower 58 model and adds an extra WOW factor! No less than Four Mercury Verado 600hp V12 outboard engines!

The Wallypower 58X employs a pair of retractable aft bulwarks and a spacious sunpad for four people, resulting in an expansive 25-square-meter beach club area with a hydraulic passerelle serving as a convenient bathing ladder. Coupled with a lower salon and master cabin/heads, this is without question 'the ultimate day boat'.

BROKER COMMENTS: WALLEYE combines "cutting-edge outboard performance with the essential access to the water that the Wallypower line is known for. As one would expect from wally, the aesthetics of the vessel are impeccably designed and finished." WALLEYE is available immediately and in perfect condition. Factory warranty remains until Spring 2025.

Optional list

Optional list

Monitor upgrade: 2x 19" LCD displays (diff. from Std)
 Autoidentification system AIS receiver SIMRAD NAIS500
 Simrad broadband radar
 Searchlight electrically controlled
 Inverter Mastervolt Mass Sine 24V 2500W
 Seakeeper Gyro Stabilizer
 Mase 15 KW generator (diff. from Std 9.kW)
 Chain counter: digital -each-
 Camera for anchor movement
 Roof: electrical opening -diff.-
 Upgrade Air-Conditioning LowerDeck and MainDeck
 N°7 white underwater lights
 Water maker predisposition
 Ice maker Hoshizaki with independent watertank in the cockpit
 Additional drawer fridge under left bench (30lt)
 A/V upgrade on external areas
 Watertight socket in Stern sunbathing cushion
 Fender rings inside the bow hatch (2 pieces)
 Hooks inside the bow hatch to hang the mooring lines (2 pieces)
 Additional pop-up fender hooks on the lateral platforms (2 pieces per platform) for side mooring
 Protections gates on the sides of the sunbed (2 pieces)
 Dinette Sofas upholstery Diff. from STD (Rada Elite – Collection Natte – Colour 700)
 Fix handrail both sides in anodized aluminum
 Aft closure for cockpit
 Camera at aft for mooring
 Installation supports for Seabobs
 Battery for emergency torch
 Discharge of black water (diff. from Std)
 Windshield film removal
 Cover for sunbathing cushion at stern and bow
 Cover for cockpit benches
 Windscreen and side windows covers
 Bow sunshade with carbon poles
 Sun canopies for cockpit
 Grey Fabric for awning diff from STD (black)
 Manual sliding Pilot seats
 Stern comfort Carbon shower
 Combi Microwave
 Apple TV Upgrade
 Magic Porthole
 Bedframe upholstery Diff. from STD (Rada Unico Nabuk colour Sandy 408)
 WC Carbon shell (diff. from Std)
 Shipyard Warranty until Spring 2025

Disclaimer

BROKERS offer the details of this vessel in good faith but cannot guarantee or warrant the accuracy of this information nor warrant the condition of the vessel. Pictures of the vessel may be taken from the catalogue. This document does not represent in any case a contractual term.
