

44' RIVARAMA SUPER - RIVA

Hull number: 113 - year of built: 2014



MAIN FEATURES

BUILDER	RIVA	MODEL	44' RIVARAMA SUPER
HULL NUMBER	113	TYPE	Motor Yachts
HULL TYPE	Planing	BOAT NAME	Heatherstream
YEAR	2014	ARCHITECT	Officina Italiana Design
HULL COLOUR	Snow White	INTERNA WOODS	Grey Oak
CONSTRUCTION MATERIAL	Fiberglass - VTR	LOA	13.40 [m] - 43.96 [ft]
BEAM	3.88 [m] - 12.73 [ft]	DRAFT	1.03 [m] - 3.38 [ft]
ENGINES	2 x MAN R6 - 800 mhp	CRUISING SPEED	36 [kn]
MAX SPEED	41 [kn]	N° GUEST CABIN	1
N° CREW CABIN	1	N. TOILETS	1
DISPLACEMENT	15,540 [kg]	ON DISPLAY AT/IN	Mallorca
COUNTRY	Spain	FLAG	Swedish
ASKING PRICE	780,000.00 [euro]	VAT STATUS	Paid

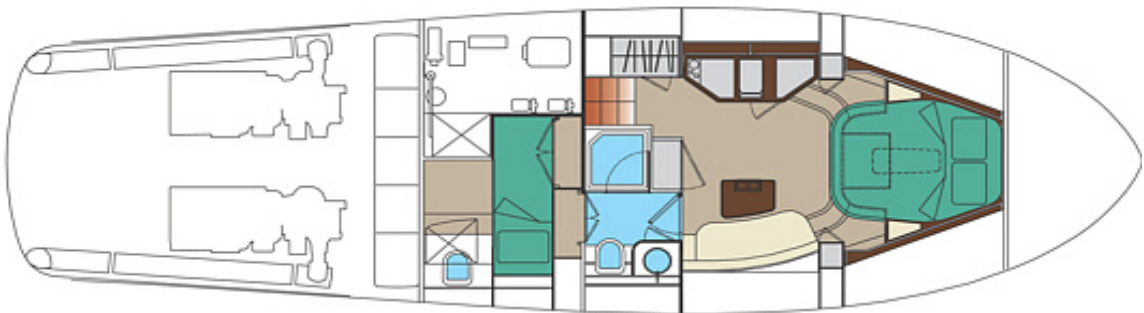
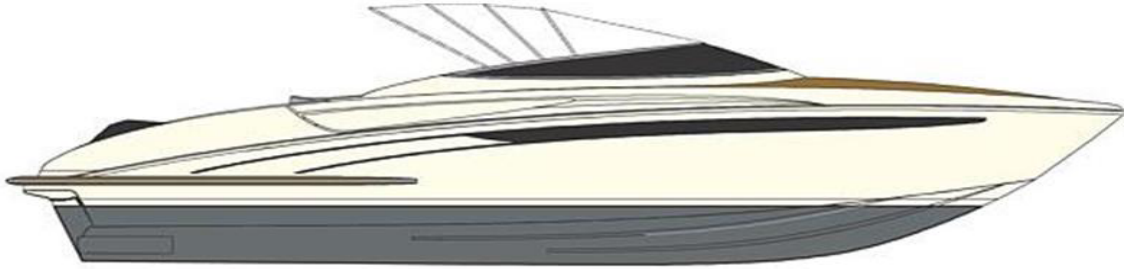

Technical information

Engines hours	314
Trasmissions	Shaft Drive
Main generator	6.5 kW 230 V 50Hz with soundproof box, exhaust gas and cooling water separator
Main generator hours	252
Fuel tank	1450 lt
Water tank	200 lt
Charge batteries	Yes
Inverter	Yes

Description per area

General description

HEATHERSTREAM is one of the world's most beautiful 40 knot sports cruisers, its dazzling finish is so beguiling, its lines so perfectly balanced that it defies belief that anyone could have designed something so beautiful. This impressively engineered 44ft (13m) beauty is brimming with exquisite, practical detailing, designed to make life on board as easy as possible. HEATHERSTREAM offers plenty of sturdy handrails, extra spring cleats and a sophisticated electronically controlled bimini that hinges beneath the deck mouldings when not in use. If you had been a motor boat designer, this is perhaps what you would have come up with.

Layout

The layout is simple, yet elegant. The entire below-decks living area is for the exclusive enjoyment of the owner. Forward, there was a double berth with reading lights and an array of beautifully crafted drawers. Amidships and to port, hidden from view, is a refrigerator, cooktop, microwave oven and stainless steel sink, with adjoining cupboards and upholstered drawers loaded with cutlery, pan set, and a china for four all emblazoned with the Riva logo. To dial it up another notch, a "champagne cooler" comes as standard, which is a deliciously decadent feature. For the Crew there is a single-berth, single-head stateroom accessed via a cockpit hatch.

Optional list

Equipment

Varnished Mahogany foredeck
 Electric bow thruster 8.4 Hp
 TV antenna
 Concealed electro-hydraulic sunshade with transparent canvasses, (1) front, (2) sides
 Fibreglass wet bar equipped with 120lt 24V refrigerator and ice-maker
 Electric anchor winch 1000W 24V with control from the helm station and bow control
 Stainless steel anchor 15Kg with 50m 8mm galvanised steel chain
 Varnished Mahogany cockpit table and cover
 Aft sunpads

Exterior

Mahogany deck wood
 External upholstery: Mambo Fabric - Pearl White colour for cockpit and stern sunpad, Brown Copper colour for foredeck cushions

Technical

Automatic pilot with rudder angle indicator interfaced with plotter/GPS
 Simrad NSS EVO3S 9" Colour plotter/GPS (New 2022)
 VHF radio telephone with DSC
 Echo-sounder
 Engine and reverse gear electronic controls with "easy dock" system
 Fibreglass helm station with Bright Black colour finish, covered steering wheel, complete engine instrumentation, magnetic compass, rev. counter with hour counter, controls, alarm lights
 Life raft (2) 4+6 people

Master Cabin and Bathroom

Bedhead and bedframe in sole leather white colour
 Carpet in grey colour
 Bed cover in grey colour
 Decorative cushions (2) in white colour
 LED TV 22"
 Porthole housing with Venetian blinds
 Double bed
 Leather sofa
 Safe
 En-suite bathroom
 Shower with teak shower floor
 Electric ceramic toilet/bidet

Galley

Corian worktop
 Glass ceramic cooking top
 Combined electric and microwave oven
 Instant refrigerator for one champagne bottle and two glasses
 Mini fridge 130l, 24/230V

Crew cabin

Single bed with mattress, pillow and bedspread
 Electric ceramic toilet/bidet

Options

Teak in the cockpit and central walkway with black caulking
 Stern steps in solid teak
 Sponge covers for cockpit seats, bow and stern sun pads
 Upgraded Stereo throughout

New Service and Start Gel Batteries (2022)
 New Battery Charger (2022)

The hull, superstructure and interior of M/Y HEATHERSTREAM was completely and professionally repainted in 2022 in an absolutely stunning and unique "Snow White" colour, with a double Aquamarine waterline stripe added as a nod to her ancestry.

Disclaimer

Brokers offer the details of this vessel in good faith but cannot guarantee or warrant the accuracy of this information nor warrant the condition of the vessel. This document does not represent in any case a contractual term.